



Request for Council Action

TO: Mayor and City Council
THROUGH: Tim Murray, City Administrator
FROM: Mark DuChene, City Engineer
MEETING DATE: March 26, 2019
SUBJECT: Ordinance 2019-2 Dedication of Public Right-of-Way for Park Avenue and 30th Street NW - First Reading

Background:

The City of Faribault acquired property along Park Avenue on February 21, 2000, and acquired property along 30th Street NW on March 20, 2019 as shown on the Rice County Right-of-Way Plat No. 35 as parcels 1 and 2, respectively. These parcels were acquired for roadway construction purposes and are only useful as right-of-way.

Rice County approved and recorded Rice County Right of Way Plat No. 35 on March 12, 2019 at their county board meeting and at this time staff is recommending that both parcels be dedicated as public right-of-way. Parcel 1 will become right-of-way for Park Avenue (CSAH 76) and will then be under Rice County's jurisdiction. Parcel 2 will become right-of-way for 30th Street NW and remain under the City's jurisdiction.

Dedicating these parcels as right-of-way makes administration of utility permits and tax records cleaner and easier.

Recommendation:

Approve first reading of Ordinance 2019-2

Attachments:

- Ordinance 2019-02
- Rice County Right-of-Way Plat No. 35

**CITY OF FARIBAULT
ORDINANCE No. 2019-2**

WHEREAS, the City of Faribault acquired property along Park Avenue on February 21, 2000, as shown and described on the Warranty Deed from ABC Bus Companies, Inc. to the City of Faribault and recorded in the office of the Rice County Recorder as Document No. 479976, and;

WHEREAS, the City obtained the property for the purposes of the construction of Park Avenue, and;

WHEREAS, the City of Faribault acquired property along 30th Street NW on March 20, 2019 as shown on the Quit Claim Deed from ABC Bus Companies, Inc. to the City of Faribault and recorded in the office of the Rice County Recorder as Document No. 714725, and;

WHEREAS, Rice County approved and recorded Rice County Right of Way Plat No. 35 on March 12, 2019 and recorded in the office of the Rice County Recorder as Document No. 714534, and;

WHEREAS, the City Council finds that the dedication of the property owned by the City of Faribault as public right-of-way as shown on the Rice County Right of Way Plat No. 35 as Parcels 1 and 2, is in the best interest of the City.

THE CITY OF FARIBAULT ORDAINS:

Section 1. Property currently owned by the City of Faribault as shown on Rice County Right of Way Plat No. 35 as Parcels 1 and 2, a copy of which is attached, is hereby dedicated as public right-of-way.

Section 2. This ordinance amendment shall take effect and be in force after its passage and publication in accordance with Section 3.05 of the City Charter.

First Reading: March 26, 2019

Second Reading: April 9, 2019

Publication Date:

Faribault City Council

Kevin F. Voracek, Mayor

ATTEST:

Timothy C. Murray, City Administrator

RICE COUNTY HIGHWAY RIGHT OF WAY PLAT No. 35

COUNTY STATE AID HIGHWAY No. 76

I hereby certify that this plat was prepared by me or under my direct supervision and that I am a duly Licensed Land Surveyor under the laws of the State of Minnesota; that the monuments for the guidance of future surveys will be correctly placed in the ground as shown; that all measurements are correctly shown on this map; and the proposed right of way boundary lines are correctly designated on this map.

Michael Fangman 3-12-2019
 Michael A. Fangman Date
 Rice County Surveyor
 License No. 48332

State of Minnesota
 County of Le Sueur

On this 12th day of March, 2019, before me, a Notary Public within and for said County, personally appeared Michael A. Fangman, known by me to be the person who did execute the above instrument, and who being by me duly sworn did say that he executed the same as his own free act and deed.

Carolyn Borst
 Carolyn Borst
 Notary Public, Le Sueur County, Minnesota
 My Commission Expires January 31, 2021

I hereby certify that this plat was approved by the Rice County Highway Department and is a true and correct representation of the highway location and that the right of way is correctly designated on the plat.

Dennis M. Luebke 3-12-19
 Dennis M. Luebke Date
 Rice County Engineer
 License No. 41491

I hereby certify that this instrument was filed for record in my office this 12th day of March, 2019, at 9:10 o'clock A.M., and was recorded as Document No. 714534

Judy Van Erp
 Judy Van Erp
 Rice County Recorder

SCALE IN FEET
 0 50 100
 1 INCH = 50 FEET

- FOUND IRON MONUMENT
- SET 1/2" X 18" ROD WITH PLASTIC CAP STAMPED LS 48332

ALL BEARINGS ARE IN RELATION TO THE PLAT OF NORTHERN INDUSTRIAL PARK FIRST ADDITION

NORTHERN INDUSTRIAL PARK FIRST ADDITION

BLOCK 2

2

66.00

32ND STREET NW

N89°57'07"E 199.93

66.00

N89°57'07"E 25.22

25.00

N7°36'22"E 670.78

BLOCK 1

N7°36'22"E 665.81

PARCEL 1

PREVIOUSLY DEDICATED TO THE PUBLIC PER PLAT OF NORTHERN INDUSTRIAL PARK THIRD ADDITION, RECORDED DOCUMENT NUMBER 487514

OUTLOT A

NORTHERN INDUSTRIAL PARK THIRD ADDITION

(EASTERLY LIMITS OF PIPELINE EASEMENT)

N14°57'31"E 403.09

PARCEL 1

Park Avenue NW / C.S.A.H. No.76

N14°57'31"E 401.20

N0°23'50"W 10.00

N89°36'10"E 175.00

30TH STREET NW

66.00

66.00

66.00

66.00

66.00

66.00

66.00

66.00

66.00

66.00

66.00

66.00

66.00

66.00

66.00

66.00

66.00

66.00

66.00

66.00

66.00

66.00

66.00

66.00

66.00

66.00

66.00

66.00

66.00

66.00

66.00

66.00

66.00

NORTHERN INDUSTRIAL PARK FIRST ADDITION

Δ=10°19'05"
 R=709.84
 L=127.83
 CHORD BEARS
 N84°26'35"E 127.66

PARCEL 2
 (TO BECOME PART OF 30TH ST NW)

Δ=2°17'17"
 R=709.84
 L=28.35
 CHORD BEARS
 N78°08'16"E 28.34

VICINITY MAP
 CITY OF FARIBAULT, MN (NOT TO SCALE)

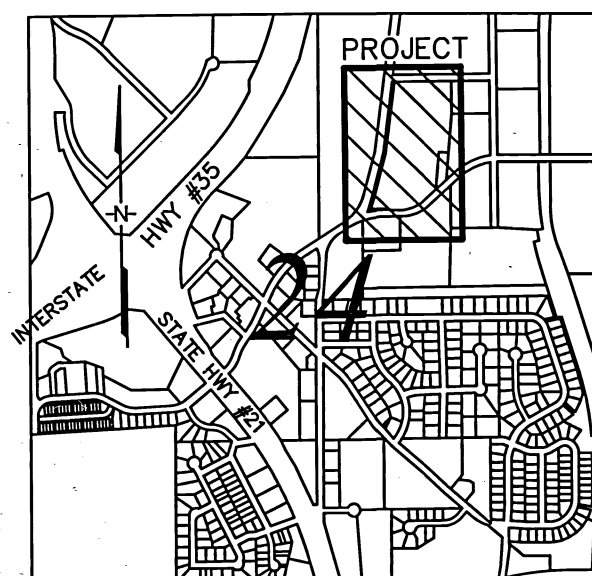

RANGE 21 WEST

PARCEL	OWNER	DEED RECORD	LOCATION	EXISTING HIGHWAY R.O.W.		NEW HIGHWAY R.O.W.		TOTAL HIGHWAY R.O.W.	
				SQ.FT.	ACRES	SQ.FT.	ACRES	SQ.FT.	ACRES
1	City of Faribault	DOC. 479976	THE WESTERLY 25.00 FEET OF LOT 1 AND THE WESTERLY 25.00 FEET OF LOT 6, ALL IN BLOCK 1, NORTHERN INDUSTRIAL PARK FIRST ADDITION, IN THE CITY OF FARIBAULT, MINNESOTA.			30,972	0.711	30,972	0.711
2	ABC Bus, Inc., A Missouri Corporation	DOC. 591000	LOT 6, BLOCK 1, NORTHERN INDUSTRIAL PARK FIRST ADDITION, EXCEPT THE WESTERLY 25.00 FEET THEREOF, ACCORDING TO THE RECORDED PLAT THEREOF, RICE COUNTY. LOT 1, BLOCK 1, NORTHERN INDUSTRIAL PARK FIRST ADDITION, EXCEPT THE WESTERLY 25.00 FEET THEREOF, ACCORDING TO THE RECORDED PLAT THEREOF, RICE COUNTY.			1,897	0.044	1,897	0.044

NOTE: The City of Faribault intends to negotiate & purchase Parcel 2 to be added to 30th Steet NW.